

CDL Components

Components for CDL Data-Logger

1.

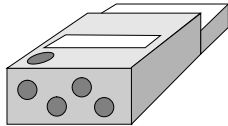

CDL Data-Logger

- CDL-1U / -2U / -4U
please see separate leaflet

2.

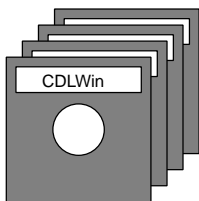

Evaluation Software CDLWin

for programming, readout and evaluating of all CDL Data-Loggers

3 1/2"-disk, software and manual in English language
(further languages on request)

- CDLWin

as option

Communication via modem

CDL-Installation/Introduction

Installation of the software, introduction of the operating staff

1/2 day, location as agreed

- CDL-Install

3.

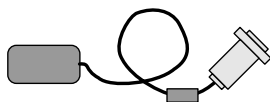
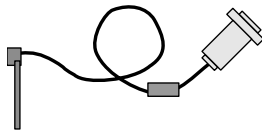

Pulsers

Several pulsers fitted with the CDL-pulse plug for our water meters are available:

- Pulser K 01 incl. CDL pulse plug
- Pulser K 02 incl. CDL pulse plug
- Pulser R 02.2 incl. CDL pulse plug
- Pulser RD 022 incl. CDL pulse plug

For very detailed measurements at very low flowrates (leakage control) a high resolution pulser is available:

For unidirectional measurement:

- Pulser OP 06 incl. CDL pulse plug
- Pulser OD 06 incl. CDL pulse plug

For bidirectional measurement (only with CDL-1U/-2U/-4U):

- Pulser OP 07-L incl. CDL pulse plug
- Pulser OD 07-L incl. CDL pulse plug

If other pulsers (gas, electricity, mag meters) are to be connected, a single pulse plug with wiring diagram is available.

- CDL pulse plug

Sensus Metering Systems
11 The Quadrangle, Abbey Park, Romsey,
Hampshire SO51 9DL UK
T +44 (0)1794 526123F +44 (0)1794 526101

Sensus Metering Systems GmbH Hannover
Meineckestrasse, 30880 Laatzen
T: +49 (0) 5102-74-0 F: +49 (0) 5102-74-341

info.int@sensus.com www.sensus.com

L S 6400 INT • Page 1 / 4

4.

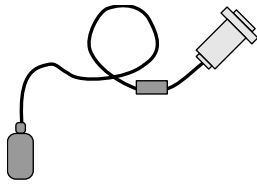

CDL-Pressure Sensors

CDL-pressure sensor for CDL-DA:

(to connect the CDL-4U, -2U, -1U a special connector [Pos. 8] is necessary)

- CDL-DS 0 ... 1 bar 3/8"
- CDL-DS 0 ... 7 bar 3/8"
- CDL-DS 0 ... 20 bar 3/8"
- CDL-DS 0 ... 10 bar 1/4"

CDL-pressure sensor for CDL-4U, CDL-2U and CDL-1U:

- CDL-DS 0 ... 10 bar 1/4"

Further pressure ranges (0.1 ... 200 bar) on request

CDL-Subfloor Hydrant Connector

To connect the CDL-pressure sensors to a subfloor hydrant there is a special connector available:

The connection is dependent on the pressure sensor

- Subfloor hydrant connector CDL-HYCON 3/8"
- Subfloor hydrant connector CDL-HYCON 1/4"

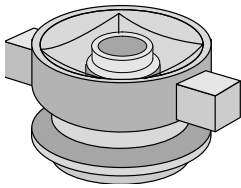

5.

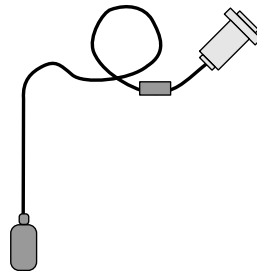

CDL-Level Sensor

For level measurement at reservoirs (measuring range 0 ... 10 m)
or for depth measurement in wells

CDL-level sensor for CDL-DA:

(to connect the CDL-4U, -2U, -1U a special connector [Pos. 8] is necessary)

- CDL-level sensor CDL-FS 0 ... 10 m (IP 68) with 15 m special cable

CDL-level sensor for CDL-4U, CDL-2U and CDL 1U:

- CDL-level sensor CDL-FS 0 ... 10 m (IP 68) with 15 m special cable

6.

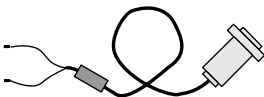

CDL-Current Interface

All standardized sensors (ph value, magmeter etc.) can be connected to CDL-logger using the CDL current interface.

The measuring circuit needs external feed.

CDL-current interface for CDL-DA

(to connect the CDL-4U, -2U, -1U a special connector [Pos. 8] is necessary)

- CDL-current interface CDL-IF 0 ... 20 mA
- CDL-current interface CDL-IF 4 ... 20 mA

CDL-current interface for CDL-4U, CDL-2U and CDL-1U:

- CDL-current interface CDL-IF 0 ... 20 mA
- CDL-current interface CDL-IF 4 ... 20 mA

7.

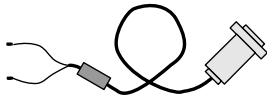

CDL-Temperature Interface

to connect a standard PT 100 temperature sensor to the analog input of the logger

CDL-temperature interface for CDL-DA/CDL-4U

- CDL-temperature interface CDL-TI 0 ... 50 °C
- CDL-temperature interface CDL-TI 0 ... 130 °C

8.



CDL/PC-Connection Cable

to connect the CDL Data-Logger to the serial interface of the PC 9-pin PC connector with an adapter for 25-pin connectors.

- CDL-PC CABLE 9/25 pins

9.



CDL-Controller

Test plug to check the CDL Data-Logger and the connected pulsers.

For the loggers CDL/LCD, CDL-4U, CDL-2U and CDL-1U this plug is not necessary.

- CDL-CONTROLLER

10.

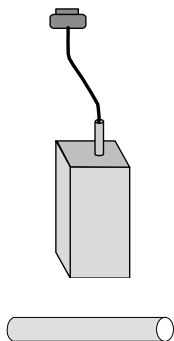

CDL-Replacement Battery for CDL/ALU

The CDL-replacement battery consists of the battery holder, the connection cable and 6 x 1.5 V alkaline cells.

For CDL/ALU the alkaline batteries may be replaced by commercial pen light batteries.

- Replacement Battery CDL/ALU: 9V

Lithium-Special Battery for CDL/LCD

- Lithium-Special Battery CDL/LCD: 7V

Batteries for CDL-4U, CDL-2U, CDL-1U

For CDL-4U, CDL-2U and CDL-1U commercial Mignon cells can be used.

11.

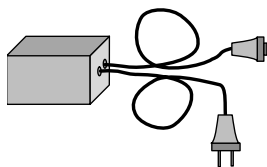

CDL-Main Supply Unit 230/115 V AC

to power the logger from the mains instead of the internal batteries.

The batteries have to remain in the logger as a buffer.

- CDL-POWER 230/12 V

For remote readout a number of accessories are available:

12.

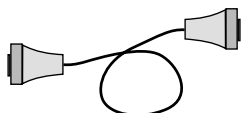

CDL/Modem-Connection Cable

to connect the CDL Data-Logger to a telephone modem.

- CDL/MOD Cable

13.

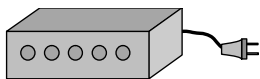

CDL-Modem

Approved modem to connect the CDL Data-Loggers to a telephone line.
Power supply 230 V.

At the other end at the PC a second modem is necessary.

- CDL Modem

14.

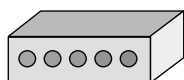

Battery Modem

to connect the CDL-logger to the telephone network.

The modem is battery powered and can be activated via PC or CDL-4U.

The housing is waterproof (IP 68)

- CDL Battery Modem